

DC BRUSHED CORELESS MOTOR ____
GRAPHITE BRUSH

AM-CL3570GAF SERIES (155°C)

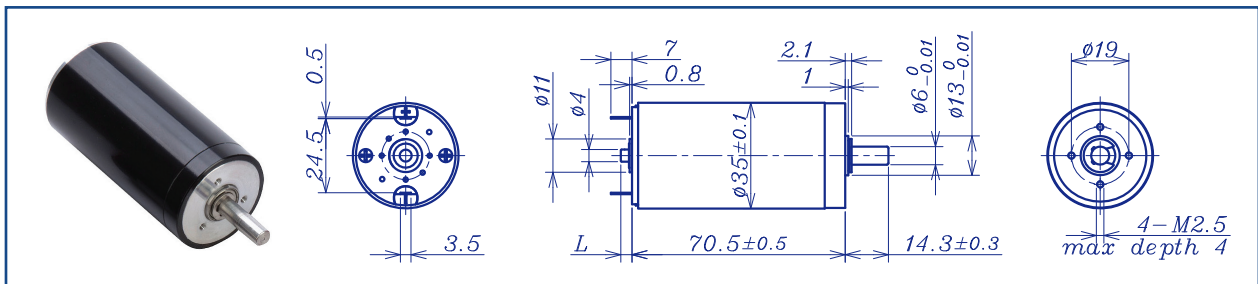

DC BRUSHED MOTOR

		Graphite brush					Ball Bearings				
Motor Model		1206	1204	2408	2406	2404	4806	4804	4803	4802	
Nominal voltage	V	12	12	24	24	24	48	48	48	48	
No load speed ±12%	rpm	6400	4320	8130	6180	4190	6310	4210	3380	1830	
No load current +150%	mA	182	125	130	96	67	53	32	25	12	
Recommended Limit for Continuous Running	Max cont. torque	mN.m	96.6	112.8	103.1	107.3	116.0	104.7	117.9	126.1	
	Rated Speed	rpm	5558	3562	7444	5467	3445	5584	3532	2648	
	Rated Current	mA	5600	4400	3800	3000	2200	1500	1100	900	
	Rated Power	W	56.2	42.1	80.4	61.4	41.9	61.2	42.8	32.7	
Starting current	mA	41379	24490	43636	25263	12060	12632	6667	4068	1290	
Stall torque	mN.m	734	643	1223	930	652	910	719	545	317	
Max power output	W	123.0	72.7	260.3	150.4	71.6	150.3	79.2	48.2	15.2	
Maximum Efficiency	%	87	86	89	88	86	87	87	85	82	
Terminal R ±12%	Ω	0.29	0.49	0.55	0.95	1.99	3.3	7.2	11.8	37.2	
Inductance (1KH _z)	mH	0.036	0.11	0.11	0.21	0.45	0.83	1.71	2.75	9.6	
Mech. time constant	ms	9.6	7.6	7.7	7.5	7.1	7.6	6.8	6.9	6.7	
Moment of inertia	gcm ²	105.3	108.7	111	108.4	105.6	104.4	110.5	106.4	110.8	
Torque constant	mN.m/A	17.8	26.4	28.1	36.9	54.4	72.3	108.4	134.8	248.1	
Speed constant	rpm/V	536	362	340	258	176	132	88	71	38	
Speed/torque gradient	rpm/mN.m	8.7	6.7	6.6	6.6	6.4	6.9	5.9	6.2	5.8	
Weight	g	348.3	350.2	350.2	350.5	348.2	347.4	351.4	348.7	351.6	

ADDITIONAL INFORMATION			
Motor thermal resistance:	9.1K/W	Motor thermal time constant:	1352S
Axial (dynamic):	5.5 N	Radial (5mm from mounting face):	28.0 N
Press-fit force (static):	100(1000) N	Max allowable screw depth into flange:	4.0 mm
Maximum radial play (5mm from mounting face):	≤0.02 mm	Axial play:	Preset
Maximum winding temperature:	155°C	Ambient temperature range:	-40 to 100°C
Standard rear shaft diameter:	4 mm	Standard rear shaft length "L":	3.7/5.5 mm

Total Length (Gearbox and Motor) _T =L ₁ +L ₂ +L ₃				
L1:36GP	L1:40GP	L1:45GP	L2:CL35	L3:EN225
39.6	46.8	60.1	70.5	10.7
				L3:EN24T
				12.0

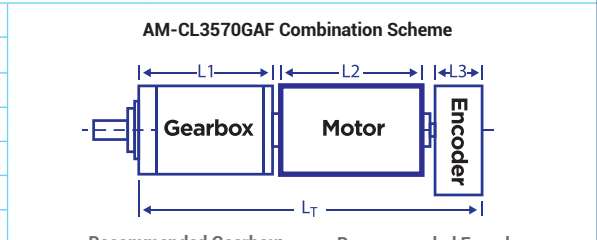

Remarks: Client can choose gearbox and encoder to match with this motor. Some combinations are listed here for reference.

Recommended Gearbox:
Planetary Gearbox:
AM-36GP
AM-40GP
AM-45GP

Recommended Encoder:
Encoder S: AM-EN2211S***
2~3 Channels
Encoder T: AM-EN2412T***
2~3 Channels

For more combination specs, visit Assun Motor website.

Motor data tested at 25°C. Motor operation exceeding continuous limits will reduce life or result in damage. At elevated ambient temperatures, load current must be reduced.

Download datasheet: <https://assunmotor.com/documents-download>

Visit Our Website and Online Shop at <https://assunmotor.com> Contact: info@assunmotor.com